

SINGLE CYLINDER TC-610H / AC-500sr

MINI AIR COMPRESSOR PART LIST

CSA file No.202925

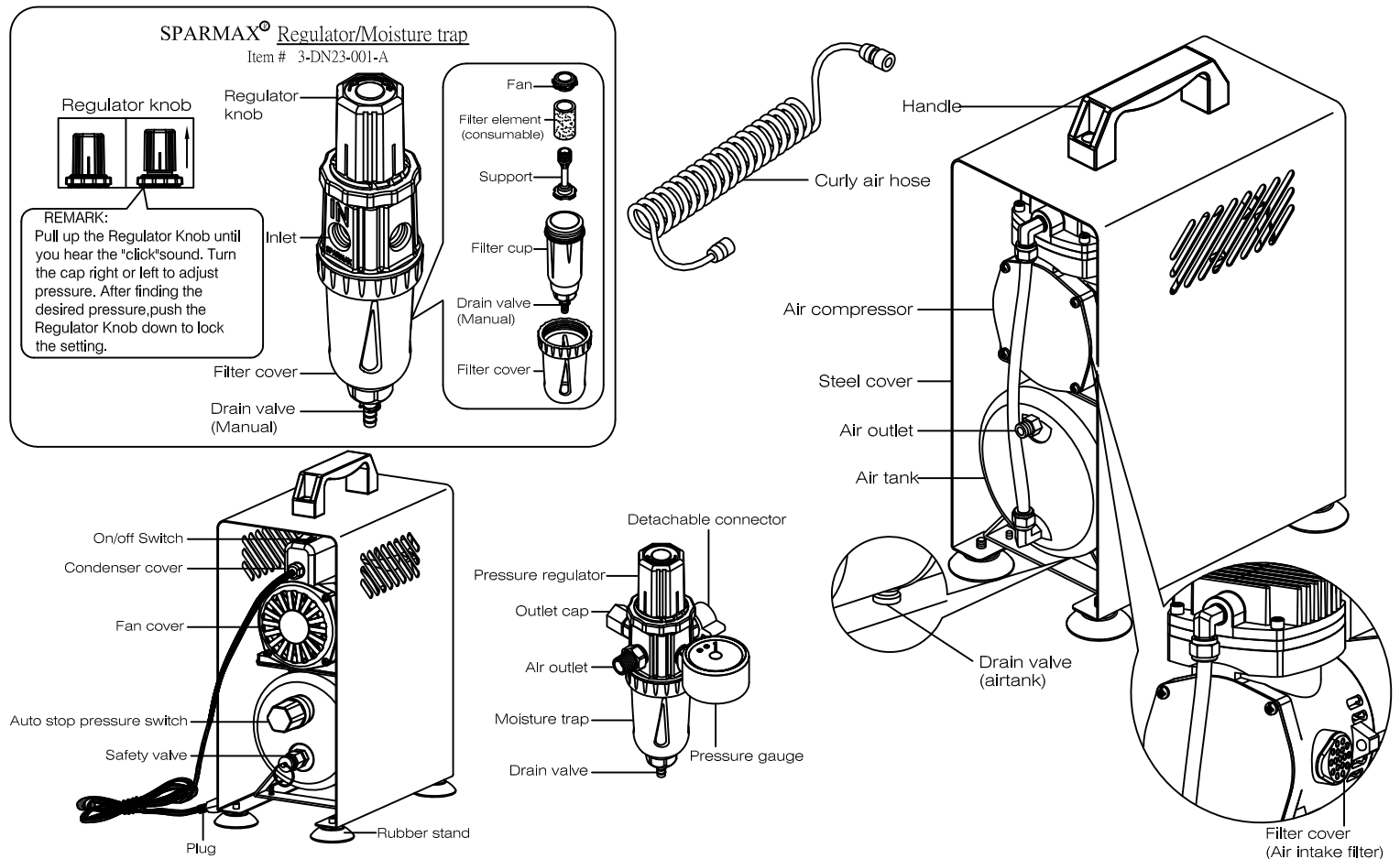

※ Please Check the Voltage/Spec. label on the machine

APPLICATION PRECAUTION

- 1) Carefully unpack the machine and check if any part is damaged during transportation. Any damage should be reported immediately to the service agent.
- 2) Connect the detachable connector to the air tank air outlet. Plug the compressor into mains supply, making sure the voltage is correct. Screw one side of the air hose onto the pressure regulator outlet and connect the other end to the airbrush. (To connect to two airbrushes, unscrew the outlet cap so another hose can also be connected to an air outlet.) To make sure all connections are tightened, it is also recommended to use Plumbers Teflon Tape on all threaded connections. (Extra fittings may be required for various airbrush brands, models, please check with the distributors for supply.)
- 3) Turn on the machine and work in a well ventilated, clean area and away from wet surfaces.
- 4) The compressor has a thermal switch that automatically shuts off itself when it becomes overheated or lacks voltage. Additionally, this model is equipped with an auto stop pressure switch. When the trigger of the airbrush is released, the compressor will stop automatically.
- 5) Adjust the pressure by pulling up the regulator knob to turn clockwise for more air, and counter-clockwise for less air. Lock the desired pressure into position by pushing the regulator knob back down until it clicks. Adjust pressure only when the compressor is turned on and connected to the airbrush.
- 6) Do not touch the air compressor during or soon after use as it may become hot.
- 7) Do not use any lubricants, or spray flammable, toxic materials as they may damage the air compressor.
- 8) After finishing with the compressor, turn the switch to off position. Drain the tank by the end of the day's use to prevent corrosion. Inspect the tank for unsafe conditions such as rust, and cracks. Never weld or drill holes in an air tank.
- 9) In case the auto stop pressure switch malfunctions, do not allow the motor to operate over 80 psi
- 10) Improper operation and dismantling of the parts by the user might damage the compressor. If any parts of the machine are damaged, it must be sent to the service agent for replacement or repair to avoid hazard. Do not attempt to fix the machine without consulting the service agent first.